

CLYFFORD STILL | MUSEUM

Private Events

About the Space



The Clyfford Still Museum is located in the heart of Denver's Golden Triangle. The two-story, 28,500-square-foot building is the perfect location for exquisite private events including the following:

- Still Signature Event
- Intimate Micro Wedding or Elopement
- Private Marriage Proposal
- Creative Team Building
- Private Meditation Morning
- Celebration of Life

The building can accommodate:

- 150 Person Cocktail Party
- 50 Person Seated Dinner
- 34 Person Micro Wedding
- 20 Person Team Building

CLYFFORD STILL | **MUSEUM**

Still Signature Event

Event: Provide a one-of-a-kind experience to your guests at your upcoming holiday party, networking event, or dinner party. Rent out the entire Museum for a Still Signature Event.

Event space on 1st floor

Galleries open for guests on 2nd floor

The Making Space open

Partial or full Museum shop open

Variety of floor plans depending on guest count

Clyfford Still preferred caterers and vendors

Capacity: 150 Person Cocktail Style, 50 Person Seated Dinner

Hours: Mondays 8 a.m.–10 p.m. or Monday–Sunday 6–10 p.m.

Cost: \$10,000 Monday 8-hour buy out; \$5,000 Monday-Sunday 4-hour buy out; \$4,000 additional fee for outdoor forecourt rental.



CLYFFORD STILL | MUSEUM

Intimate Micro Wedding or Elopement



Event: Looking to have an intimate wedding day in a beautiful location? Look no further, get married in the Clyfford Still galleries with your closest friends and family!

- Choice of gallery (dependent on size of wedding)
- Ceremony setup in gallery with chairs
- Marriage certificate signing location
- Cocktail party and/or dinner on 1st floor
- Variety of floor plans depending on guest count
- Gallery and forecourt access for wedding photos
- A/V for slideshow, music, and wireless microphone
- Clyfford Still preferred caterers and vendors

Capacity: 34 people or less

Hours: Mondays 8 a.m.–10 p.m. or Monday–Sunday 6–10 p.m.

Cost: \$5,000 Monday-Sunday 4-hour buy out; \$4,000 additional fee for outdoor forecourt rental.

Private Proposal

Event: A unique private photo tour with you and your partner to lead into a secretly planned proposal.

Exclusive access to Museum galleries

Private photo tour of the Museum with you and your love

Pre-choose a piece of artwork or location for your proposal

Professional photographs of proposal available

Intimate bistro table set up with champagne, silk rose, and chocolate on 1st floor

Capacity: You and your love

Hours: Tuesday–Sunday 5–6 p.m.

Cost: \$750 private proposal

Preferred Professional Photographers available for hire.

(Photo packages range from \$350-\$1,500)



CLYFFORD STILL | MUSEUM

Creative Team Building



Event: Book the perfect corporate or organizational team building morning at the Clyfford Still Museum.

Guided tour through the galleries

Educator-led activity in The Making Space (options available to choose what is best for your team)

Coffee and pastries

Museum Shop open

Museum access all day

Capacity: 20 person or smaller team

Hours: Tuesday–Sunday 8–10 a.m.

Cost: \$2,400

Private Meditation Morning

Event: Treat your team or friends to a wellness retreat. The Clyfford Still Museum has the perfect urban getaway for rest and relaxation.

Choose a local wellness artist to guide your group in activities such as guided meditation and sound baths

Self-guided tour of art galleries

Coffee and pastries

Museum Shop open

Museum access all day

Capacity: 20 person or smaller team

Hours: Tuesday–Sunday 8–10 a.m.

Cost: \$2,400



Celebration of Life



Event: Celebrate and remember your loved ones at the Clyfford Still Museum while enjoying the tranquility of the galleries.

Memorial space on 1st floor

Galleries open for guests on 2nd floor

The Making Space open

A/V for slideshow, music, and podium included

Museum rentals included

Museum Shop removed (unless requested to stay open)

Clyfford Still preferred caterers and vendors

Capacity: 100 Person Cocktail Style, 50 Person Seated Dinner

Hours: Tuesday–Sunday 6–8 p.m.

Cost: \$3,500

1st Floor Clyfford Still Museum

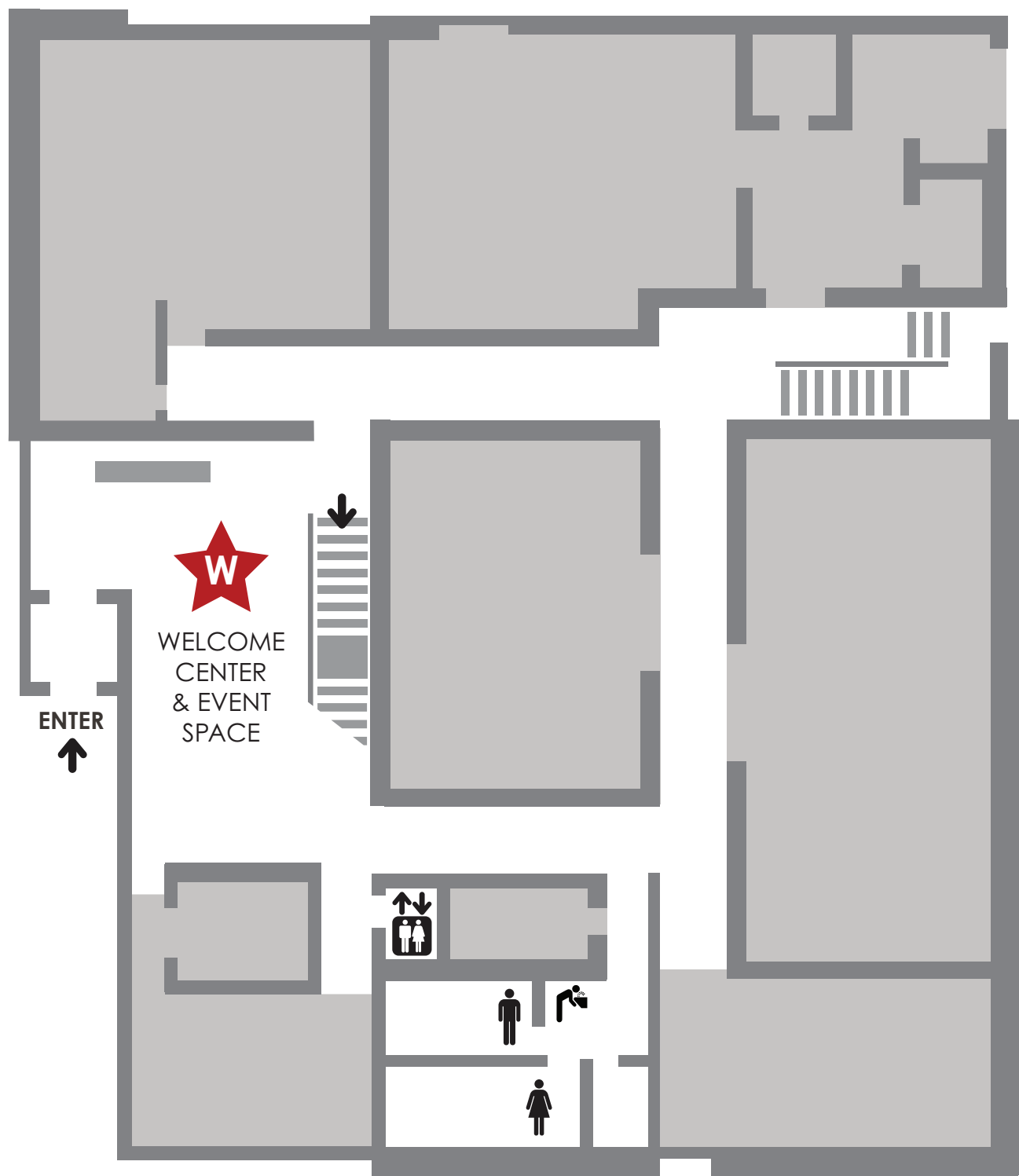

2nd Floor Clyfford Still Museum



Rental Items:

Item	Quantity	Price
Grey Chairs	100	\$5
Cocktail Tables		\$15
Red Bistro Table + 2 Chairs	4	\$25
4 ft Table	4	\$10
6 ft Table	6	\$15
8 ft Table	1	\$20

Extended Hours:

Each additional hour of event time - \$500

Private Event Add-Ons:

Educator-led tours - \$250

Educator-led activity in The Making Space - \$250

VIP Behind the Scenes Tour - \$750

Pricing:

15% off base cost for minority- and women-owned businesses, as well as non-profit organizations.

Donors at certain levels receive exclusive discounts.

Additional fees may apply depending on the needs related to the event.

About the Museum

Clyfford Still: Considered one of the most important painters of the 20th century, Clyfford Still (1904–1980) was among the first generation of Abstract Expressionist artists. The Clyfford Still Museum collection represents more than 93 percent of the artist's lifetime output, including approximately 3,125 works created between 1920 and 1980 as well as his complete archives.

The Mission: As the steward of Clyfford Still's art and legacy, the Clyfford Still Museum's mission is to:

- Preserve, exhibit, study, and foster engagement with its unique collections;
- Generate outstanding exhibitions, scholarly research, educational and other cross-disciplinary programs that broaden the definition of a "single-artist" museum; and
- Be a gathering place for the exploration of innovation and individual artistic endeavor.

CLYFFORD STILL | MUSEUM

Address: 1250 Bannock Street Denver, CO 80204

Phone: 720-354-4880

Email: info@clyffordstillmuseum.org

Web: clyffordstillmuseum.org